

# RST<sup>®</sup> MINI TECHNICAL DATA

	RST16i2/i3	RST16i4/i5
Rated voltage	250/400 V	250/400 V
Rated current	16 A	16 A
Number of poles	2- or 3-pole	4- or 5-pole
Connectable cable diameter*	5.0 - 9.5 mm	7.1 - 13 mm
Connector temperature range	- 40 °C to 100 °C	
Material	Contact parts: Brass, surface-treated Housing parts: Polyamide, halogen-free, V2 Sealing material: NBR	
Pollution degree	3 (when connected)	
Protection rating	IP66/68 (3m; 2h)/69	
IK code	IK07 (2 joules)	
Mating cycles	according to IEC 61535 100x without load and 50x under nominal load (cos phi = 0.6)	
Certificates / approvals	VDE (IEC 61535), UL (UL 2238), CSA (C22.2 No.182.1 / C22.2 No.182.3), RINA, LR, DNV/GL, BV	

\*Other diameters on request

# RST<sup>®</sup> MINI DIMENSIONS

## RST16i2/I3

### CONNECTOR

female

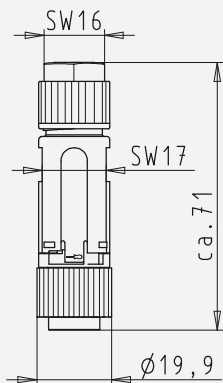

male

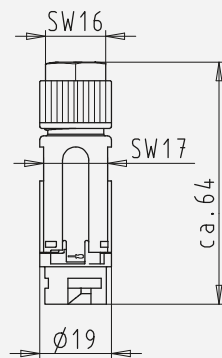

### DEVICE CONNECTOR

female

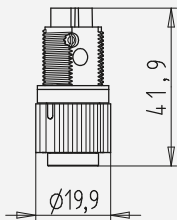
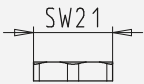

male

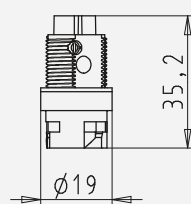
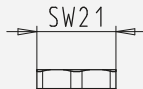

### DISTRIBUTOR

1E / 2A

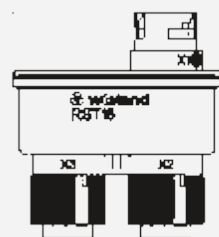
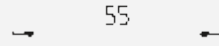
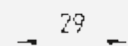

## RST16i4/I5

### CONNECTOR

female

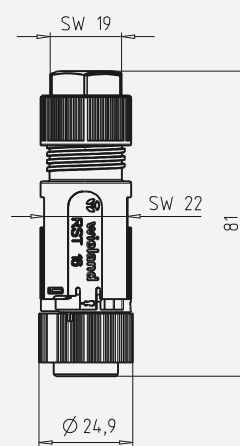

male

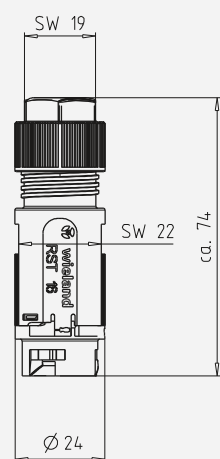

### DEVICE CONNECTOR

female

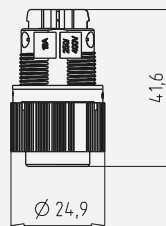
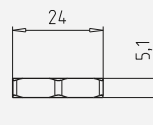

male

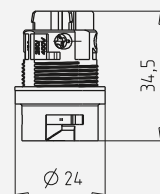
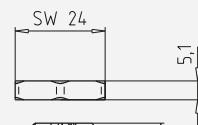

### DISTRIBUTOR

1E / 2A

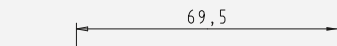
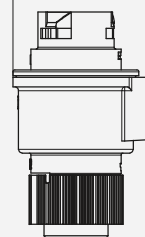
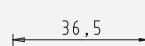



**NOTE:** The drawing for your product can be found in the Download area of the relevant Art.No. at [eshop.wieland-electric.com](http://eshop.wieland-electric.com)

# RST<sup>®</sup> MINI CABLE PREPARATION

## Connectable cable cross-sections

RST16i2/i3	Solid	Fine-wired, no cable end sleeve <sup>1)</sup>	Fine-wired, with cable end sleeve
Screw connection	0.2 - 2.5 mm <sup>2</sup>	0.25 - 1.5 mm <sup>2</sup>	0.25 - 1.0 mm <sup>2</sup>
RST16i4/i5	Solid	Fine-wired, no cable end sleeve	Fine-wired, with cable end sleeve
Screw connection	0.2 - 2.5 mm <sup>2</sup>	0.25 - 2.5 mm <sup>2</sup>	0.25 - 1.5 mm <sup>2</sup>

 The RST<sup>®</sup> range of screw terminal connections is suitable for connecting unprepared cables to EN 60999-1.

 1) From 01.07.2020: The maximum connectable cross-section of all connectors and device connections of the RST<sup>®</sup> MINI series is extended to 2.5 mm<sup>2</sup> for fine-wired cables without no cable end sleeves.

## Sheath strip and wire strip lengths

Cable	PE	N, L, 1, 2, 3
Sheath strip length y	30	25
Wire strip length x	8	8

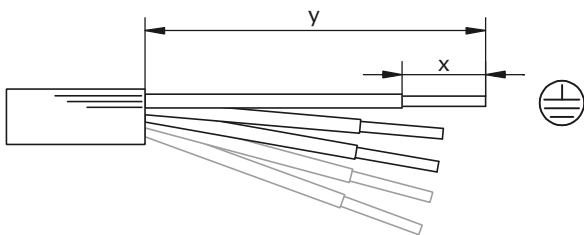

# RST<sup>®</sup> MINI DERATING CURVES

## RST16i2/RST16i3

Derating curve to DIN EN 60512-2, Date: 2003-1

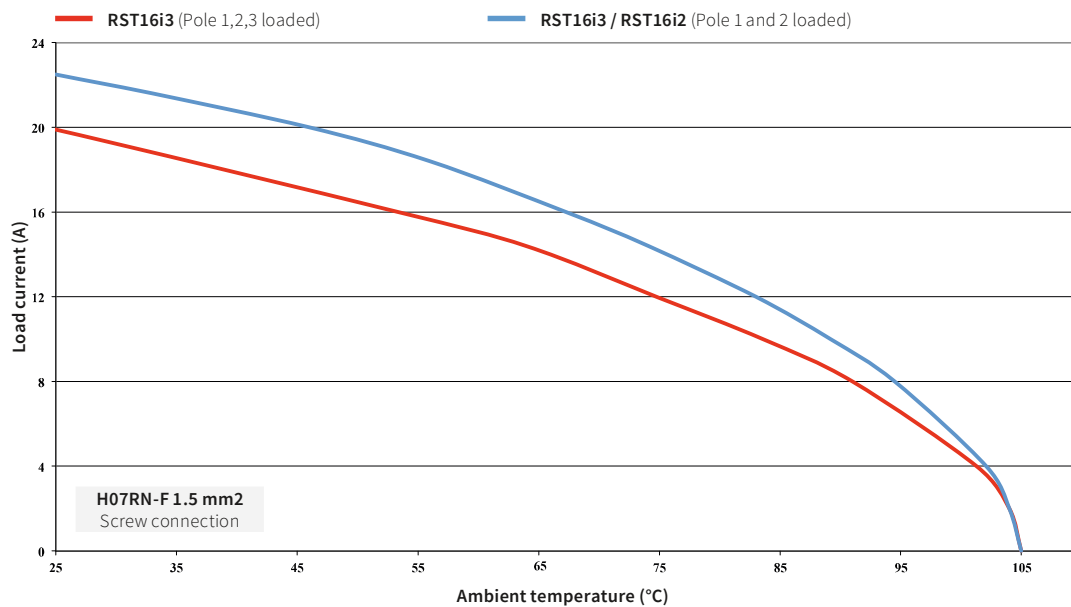

## RST16i4/RST16i5

Derating curve to DIN EN 60512-2, Date: 2003-1

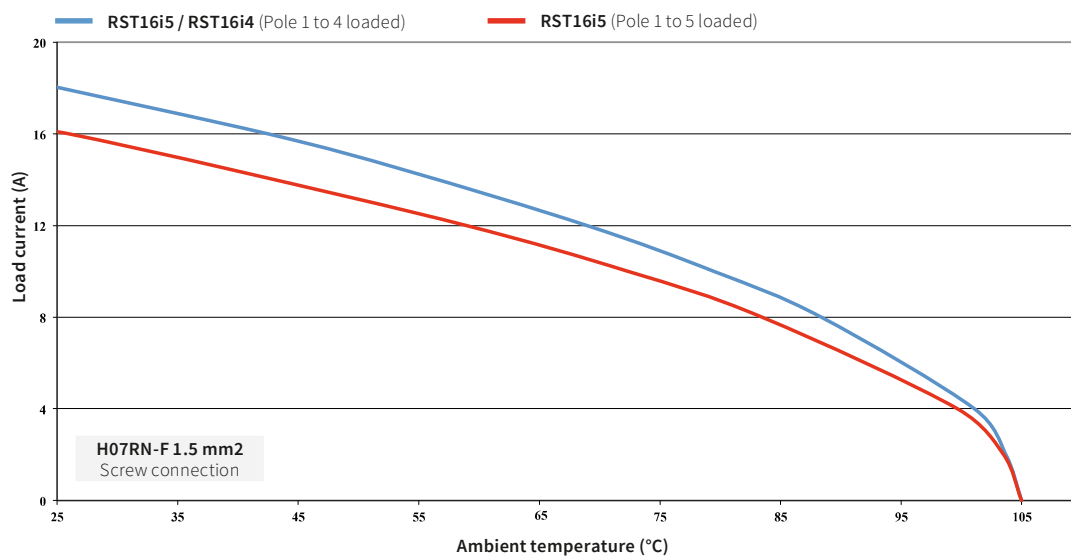

# RST® MINI ASSEMBLY INSTRUCTION

## CABLE ASSEMBLY

Screw connection:

- Blade DIN 5264 A, ground
- Drive PZ1
- Tightening torque: 2-, 3-pole: 0.4 Nm 4-, 5-pole: 0.5 Nm

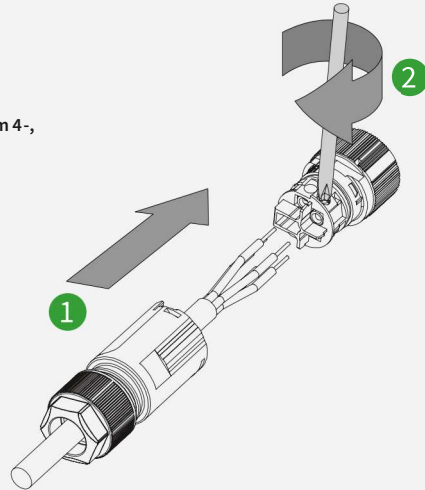

## CLOSING THE CONNECTOR

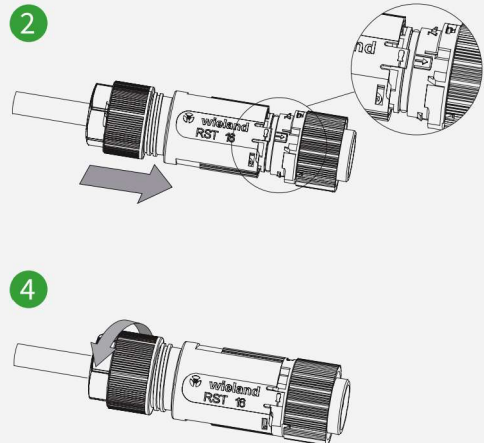
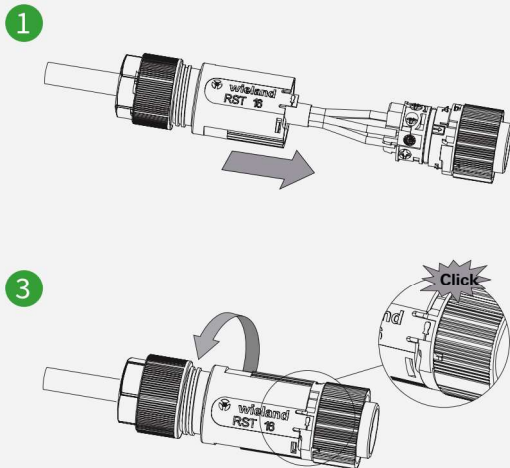

Gland nut:  
- tightening torque typ. 1.5 - 2 Nm

## INSERT AND LOCK

Connectors lock automatically

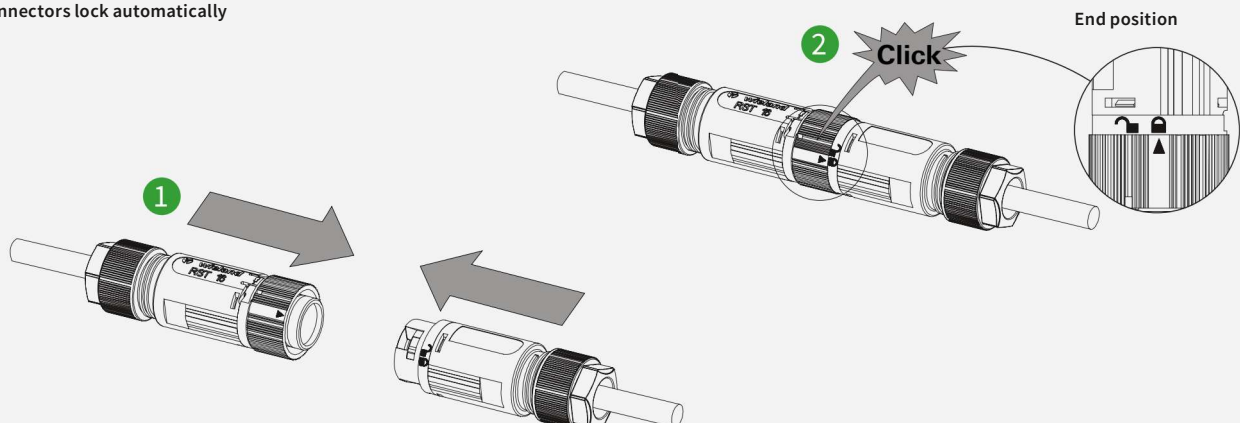

## UNLOCK AND DISCONNECT

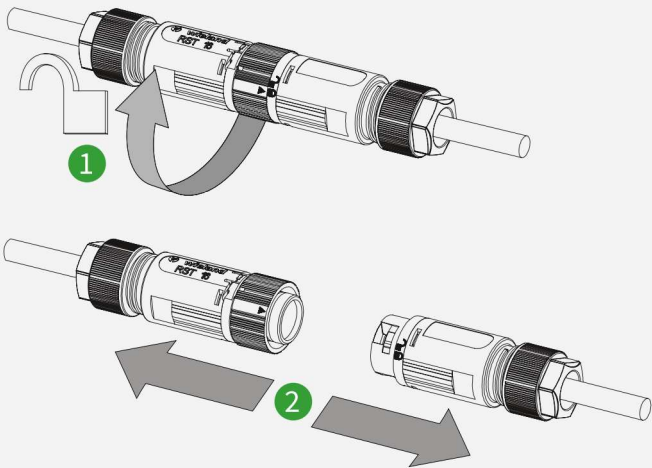

## OPENING THE CONNECTOR

Screwdriver: Blade DIN 5264 A, ground

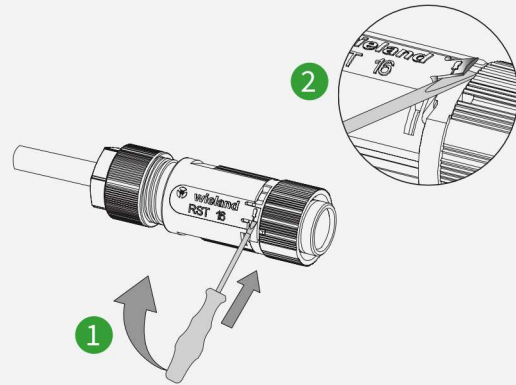

## HOUSING INSTALLATION

Nut: Tightening torque typ. 1.5 Nm

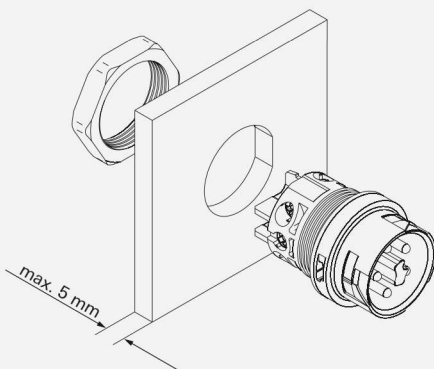

Dimension drawing of the opening for housing installation.

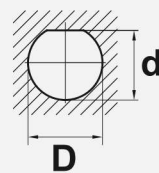

	D (mm)	d (mm)
2-, 3-pole	16.2 <sup>+0.1</sup>	14.6 <sup>+0.1</sup>
4-, 5-pole	20.4 <sup>+0.1</sup>	19.4 <sup>+0.1</sup>

**i** Proceed in the same way for 2 to 5-pole connectors. Observe the pole configuration.



**NOTE:** Please note that electrical connections and installations must be carried out only by appropriately trained specialists. The Assembly instructions accompanying the product must be observed! The relevant Assembly instruction BA000960 can be found online in the download area of the product concerned: [eshop.wieland-electric.com](http://eshop.wieland-electric.com)